

Integrated 200W AGV Steering Wheel Assembly Drive 3000rpm Speed High Durability

Our Product Introduction

for more products please visit us on roboticsagv.com

Basic Information

- Place of Origin: GUANGZHOU
- Brand Name: TIANYUE
- Certification: 3c.ce
- Model Number: QDL-150-200
- Minimum Order Quantity: 1
- Packaging Details: wooden box
- Delivery Time: 15 work days
- Payment Terms: T/T
- Supply Ability: 100



Product Specification

- Wheel Diameter: Diameter 150mm
- Motor Way: Servo Motor
- Voltage: 48V
- Driving Power: 200W
- Series Type: Differential Drive
- Highlight: AGV Steering Wheel 200W, AGV Steering Wheel 3000rpm, 3000rpm agv wheel drive

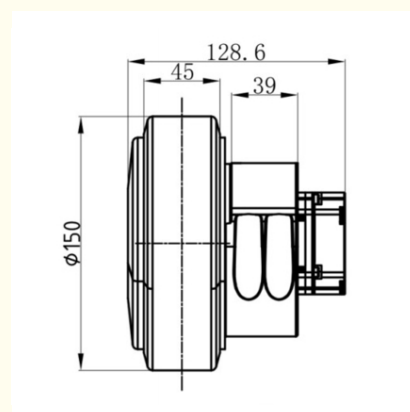

More Images

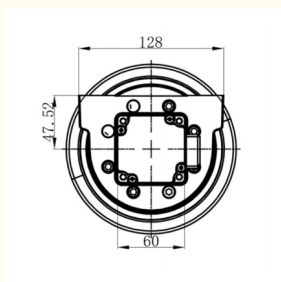
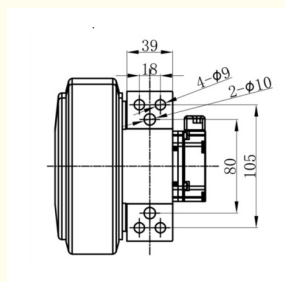

Product Description

AGV steering wheel assembly drive, differential drive series integrated 200W drive wheel diameter 150mm

Motor Type	Specifi cation
Power [W]	200
Voltage [V]	24/48
Current [A]	4.5/9.9
Speed [rpm]	3000
Gear Ratio [i]	16
Load Capacity [kg]	400
IP Rating	65

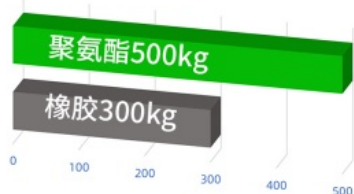

The green bar represents "Polyurethane (聚)" with a load capacity of 500 kg.
The gray bar represents "Rubber (橡)" with a load capacity of 300 kg.



Guangzhou Tianyue Automation Technology Co., Ltd.



13570415240



mkliangjintian@gmail.com



roboticsagv.com

Shop 23,24-101 ,32 Lihong Bei Lu,Jiutan Cun,Huadu District,Guangzhou City,China