



Diameter 240mm AGV Steering Drive Wheel Integrated 200W Differential Drive

Our Product Introduction

Basic Information

- Place of Origin: GUANGZHOU
- Brand Name: TIANYUE
- Certification: 3c.ce
- Model Number: CS-240-200
- Minimum Order Quantity: 1
- Packaging Details: wooden box
- Delivery Time: 30 work days
- Payment Terms: T/T
- Supply Ability: 100



Product Specification

- Wheel Diameter: Diameter 240mm
- Motor Way: Servo Motor
- Voltage: 48V
- Driving Power: 200W*2
- Series Type: Differential Drive
- Highlight: 240mm AGV Steering Drive Wheel, AGV Steering Drive Wheel 200W, 240mm agv drive unit

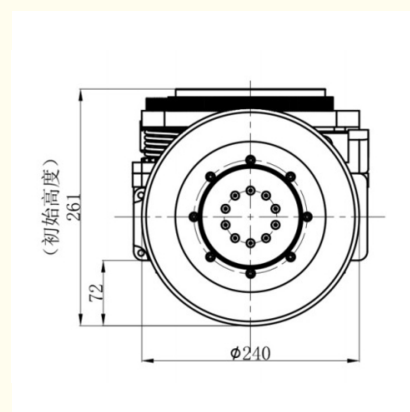

More Images

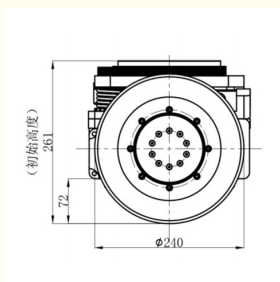
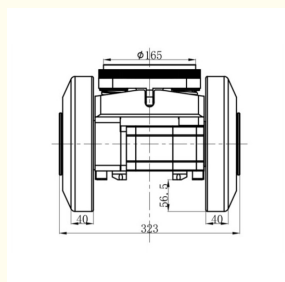

for more products please visit us on roboticsagv.com

Product Description

AGV steering wheel assembly drive, shock absorption differential drive series integrated 200W drive wheel diameter 240mm

Motor Type	Specification
Power [W]	200
Voltage [V]	24/48
Current [A]	4.5/9.9
Speed [rpm]	3000
Gear Ratio [i]	16
Load Capacity [kg]	400
IP Rating	65

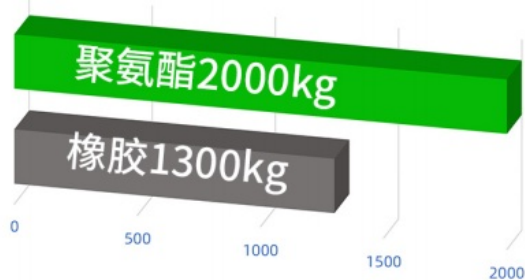

The green bar represents "Polyurethane (聚氨酯)" with a load capacity of 2000 kg.
The gray bar represents "Rubber (橡胶)" with a load capacity of 1300 kg.



Guangzhou Tianyue Automation Technology Co., Ltd.



13570415240



mkliangjintian@gmail.com



roboticsagv.com

Shop 23,24-101 ,32 Lihong Bei Lu,Jiutan Cun,Huadu District,Guangzhou City,China